

# SAMUEL HEATH

PRODUCT DATA SHEET

## P8072 & P8073 BATHROOM LOCKING SNIB CATCH



**P8072T**



**P8072CR**



**P8073T**



**P8073CR**

SAMUEL HEATH

*since 1820*

# Installation

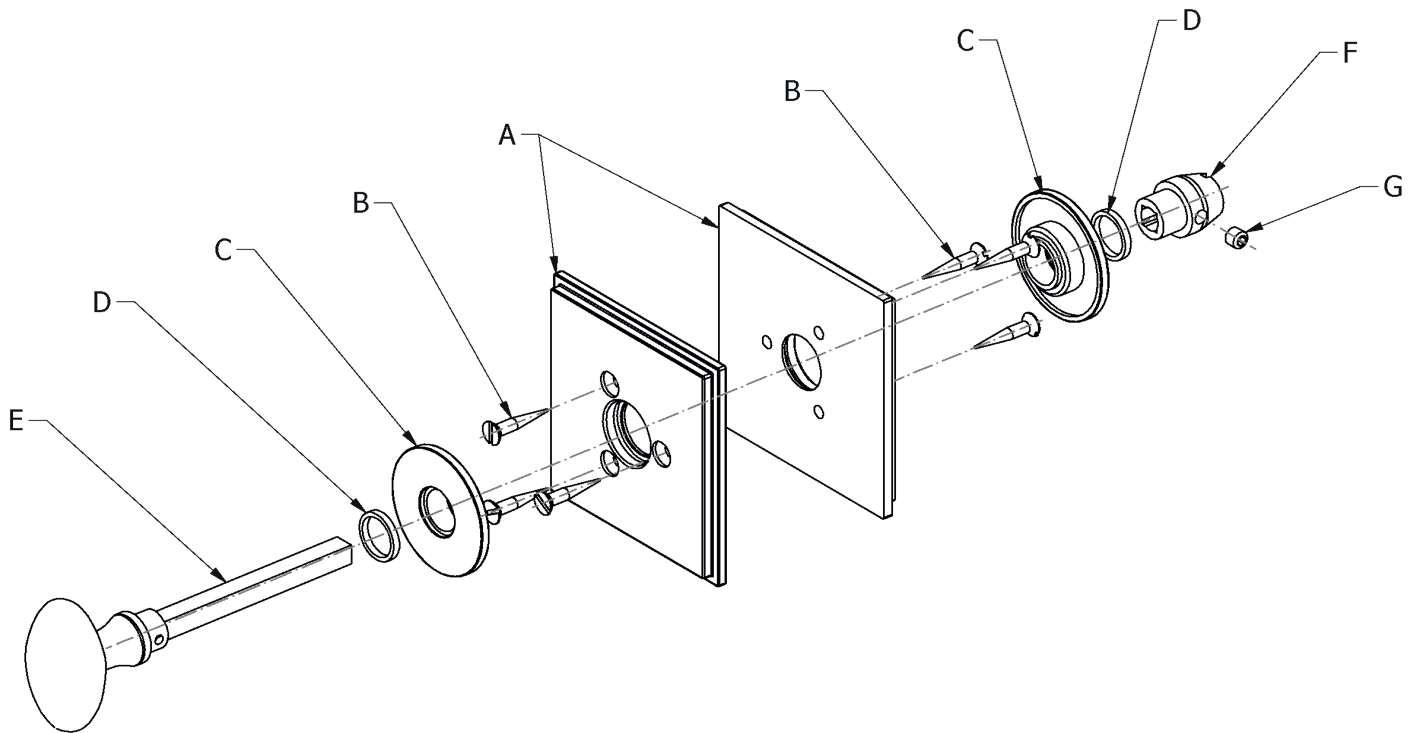

1. Drill the spindle hole in the door to 10mm.
2. Attach plates (A) to the door using screws (B).
3. Screw cover (C) onto the plates (A).
4. Assemble washers (D) onto the covers (C).
5. Feed the spindle through the door. **The spindle should project 5mm external to the cover which will allow grub screw location** (The spindle should be cut to size accordingly).
6. Fit the coin release (F) to the spindle (E) locating securely with the grub screw (G) underneath.

## SAMUEL HEATH

Head Office and Customer Service  
Leopold Street  
Birmingham  
England  
B12 0UJ

T: +44 (0)121 766 4200  
F: +44 (0)121 772 3334

Info@samuel-heath.com  
www.samuel-heath.co.uk

US Customer Service

usa@samuel-heath.com  
Federal I.D. No. 58-1504682  
www.samuel-heath.com