

# SAMUEL HEATH

## Product Data Sheet

N510-3

## LED Double Arm Illuminated Pivotal Mirror

IP44 Approved

Power Requirements 240V - 0.35A



### PACK CONTENTS CHECK LIST

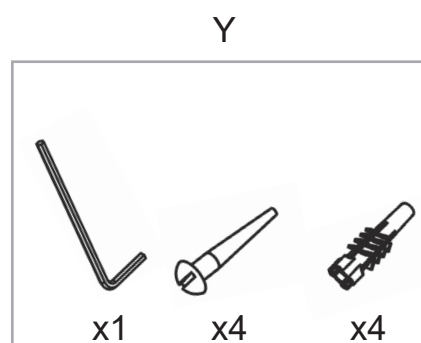
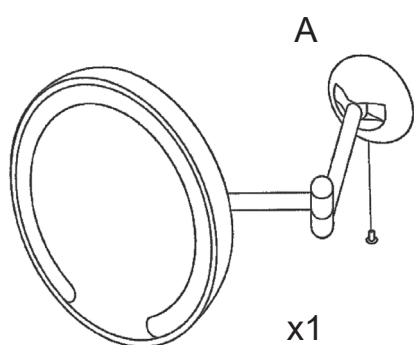

## Fitting Instructions

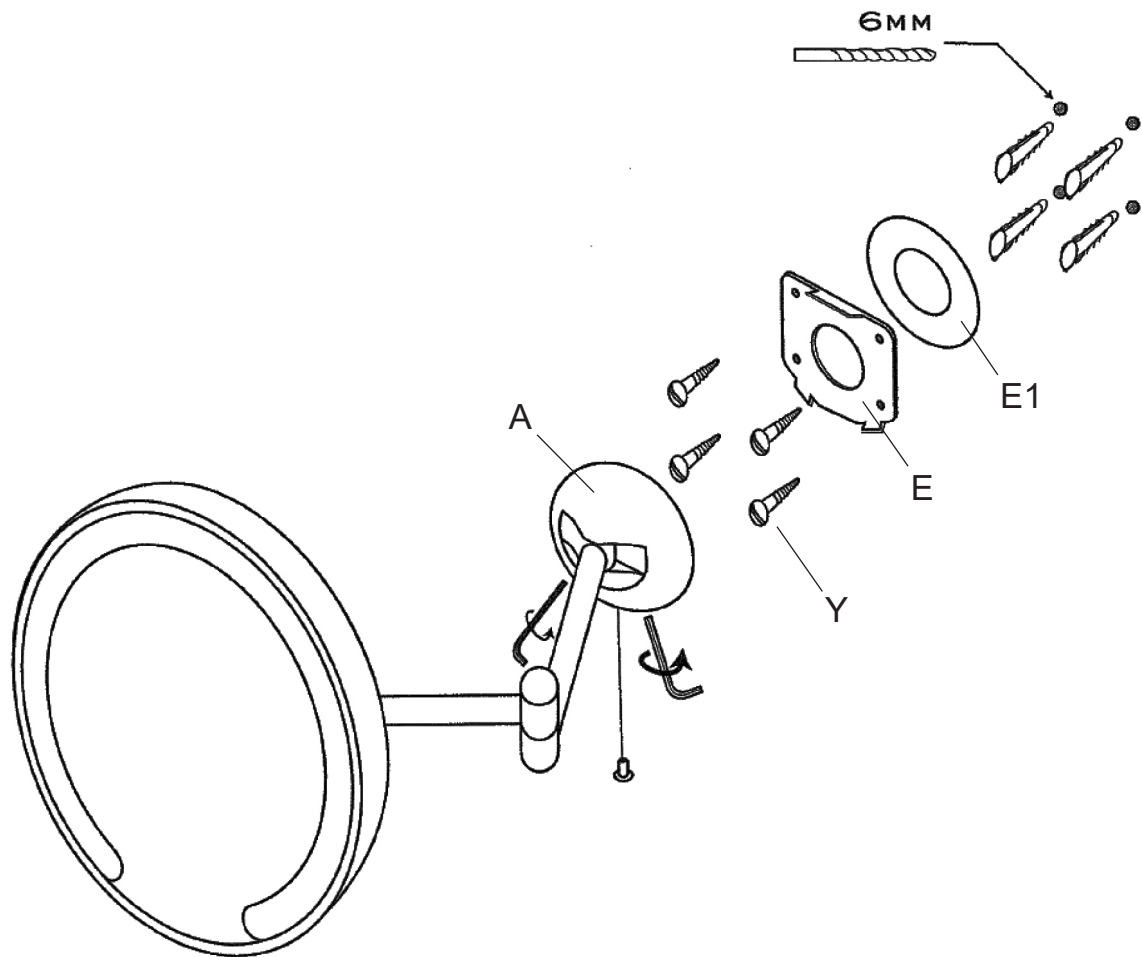

- This light fitting should be installed by a qualified electrician who is fully conversant with relevant regulations.
- This product contains LED bulbs and is therefore non-serviceable.

**Notes:** Before installation turn off power, ensure that the point of connection to the light has been isolated and is free from current.

Due to leverage when the mirror is fully extended from the wall, it is vital that the chassis (E) is anchored securely.

## Fitting Instructions

1.

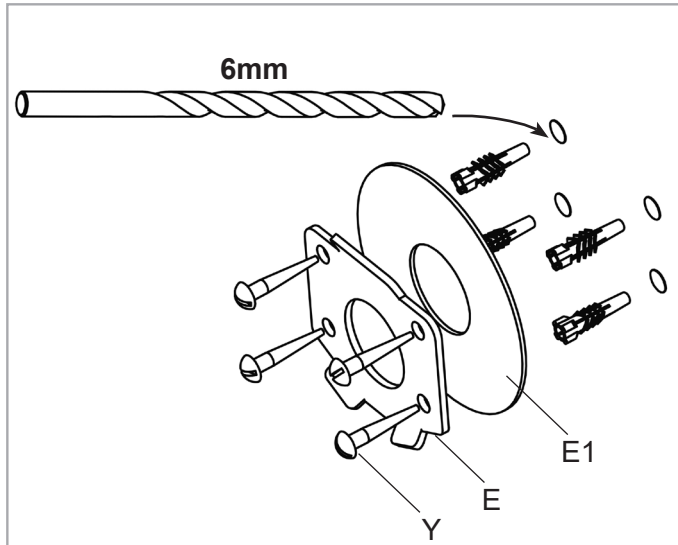

2.

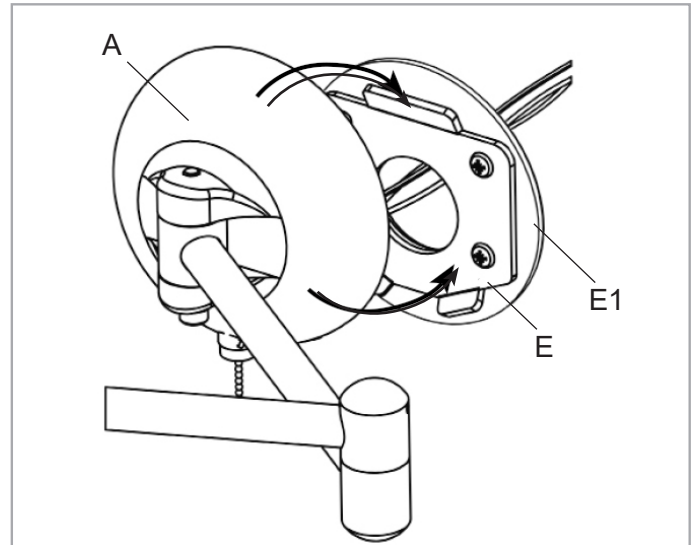

3.

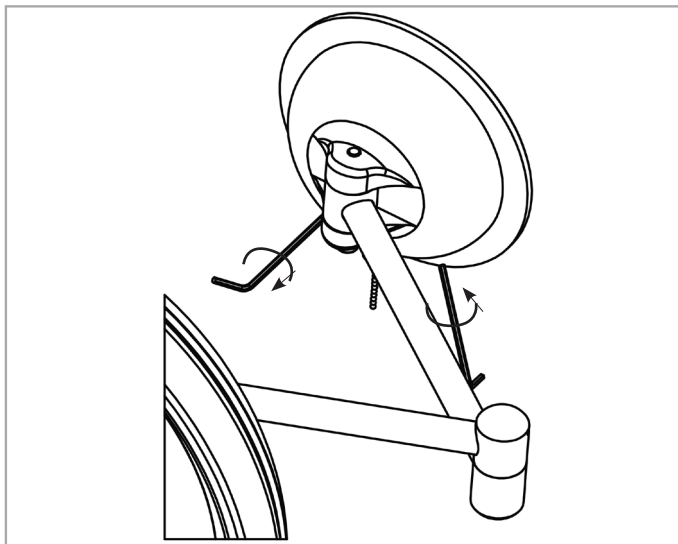

1. Fix chassis (E) and pad (E1) to wall using screws (Y).
2. Loosen grub screws in (A) then hook mirror over tab.
3. Tighten grub screws securely.



**SAMUEL HEATH**  
**Head Office and Customer Service**  
Leopold Street  
Birmingham  
England  
B12 0UJ

T: +44 (0)121 766 4200  
F: +44 (0)121 772 3334

[Info@samuel-heath.com](mailto:Info@samuel-heath.com)  
[www.samuel-heath.com](http://www.samuel-heath.com)

**US Customer Service**  
[usa@samuel-heath.com](mailto:usa@samuel-heath.com)  
Federal I.D. No. 58-1504682  
[www.samuel-heath.com/us](http://www.samuel-heath.com/us)